

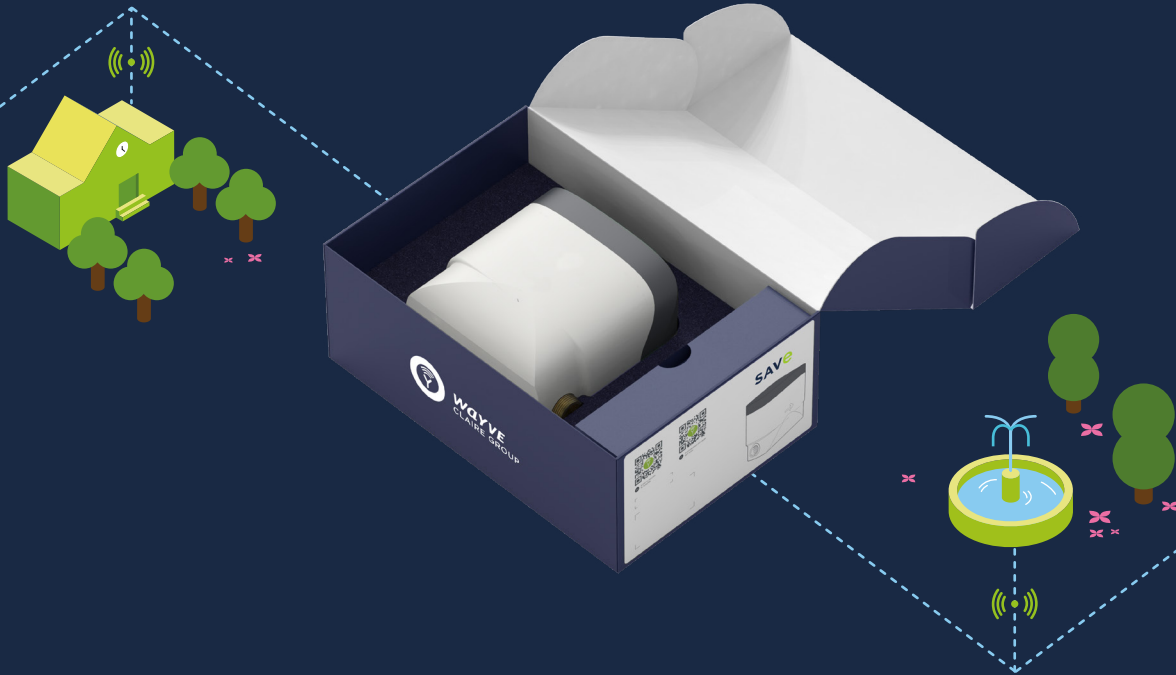

**WAYVE**  
CLAIRE GROUP



# SAVE

## CONTROL... WATER

Water management issues in public places?  
Schools, stadiums, parks, cemeteries, lavatories...  
Private places with seasonal occupation : houses, factories...?  
Unintended openings?  
Consumption based on seasonal peaks?  
How to avoid overconsumptions? leaks?

**SAVE BOX IS A TURNKEY SOLUTION TO SAVE WATER**

**LEAKAGES  
AND DAMAGES LIMITED**

**WATER THEFTS  
LIMITED**

**TRAVELS  
MINIMIZED**

+33 (0)2 54 04 04 04 - info@wayve.fr - www.wayve.fr



## WEB PLATFORM



DATA TRANSMISSION | REMOTE CONTROL  
FLEET MONITORING | NOTIFICATIONS | LEAK ALERT  
HISTORY AND STATISTICS | FLEET GEOLOCATION

## APP IOS & ANDROID TABLET AND SMARTPHONE

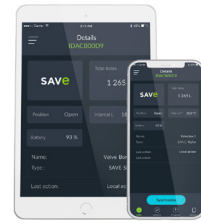

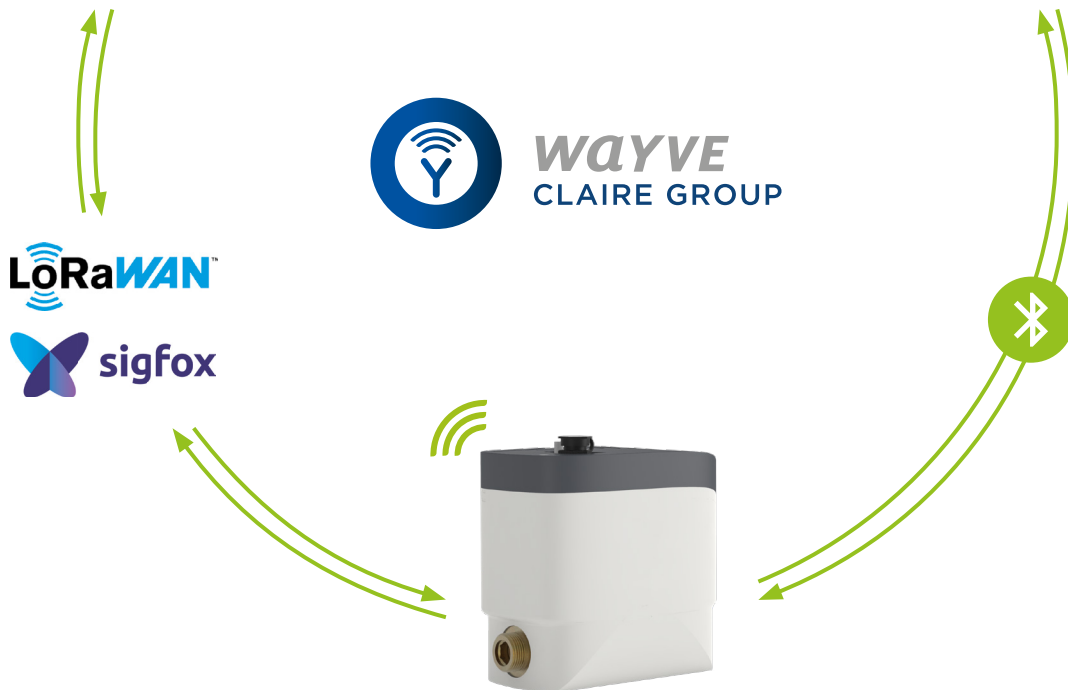

OPENING TIMES PROGRAMMING  
AUTOMATIC ACTION IN CASE OF LEAK  
SYSTEM CONTROL | HISTORY AND STATISTICS  
SYSTEM GEOLOCATION





**SAVE BOX**  
CONTROLLED & PATENTED 3 POSITIONS SYSTEM  
(OPEN, CLOSED, LIMITED FLOW)

## ONLINE MODE

- |  |   |   |   |  |
|--|---|---|---|--|
|  <b>ACCESS TO SERVICE</b>  | + |  <b>EXPLOITATION</b>   | + |  <b>SERVICE GUARANTEE</b> |
| <ul style="list-style-type: none"><li>• Wayve box</li><li>• Wayve mobile app</li><li>• Quickstart guide</li><li>• Customer support</li><li>• Software updating</li></ul> |   | <ul style="list-style-type: none"><li>• Sigfox or LoRaWAN connection</li><li>• Web platform</li><li>• Optional assistance and delegated supervision</li></ul> |   | <ul style="list-style-type: none"><li>• 5 years commitment</li></ul>   |

## LOCAL MODE

- |  |   |  |
|--|---|--|
|  <b>ACCESS TO SERVICE</b>  | + |  <b>SERVICE GUARANTEE</b> |
| <ul style="list-style-type: none"><li>• Wayve box</li><li>• Wayve mobile app</li><li>• Quickstart guide</li><li>• Customer support</li><li>• Software updating</li></ul> |   | <ul style="list-style-type: none"><li>• 5 years commitment</li></ul>   |

Scan to access tutorials

